

## H-RG SMD Potting Boxes (fw)

The potting boxes (fw) are made in gfr Polyphenylene Sulfide PPS of type torA504 (RTI long-range temperature +130°C) and are suitable for reflow soldering. Pin material: tin bronze, tinned. Special materials – e.g. irradiated cross-linked – and designs on request, dimensions in mm/[inch](#).

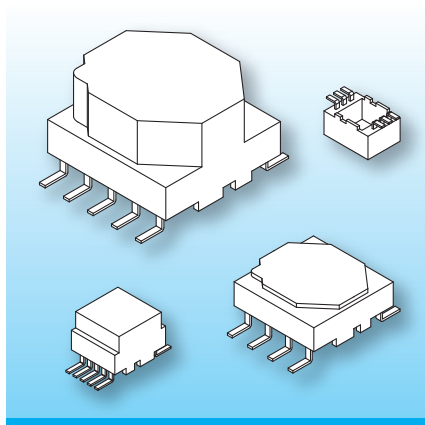

The potting boxes are for surface mounting, as is common f.e. with filter chokes and ISDN transformers. The terminal type fw ensures a defined distance between potting box and pcb. The binding-on / soldering section of the terminal is accessible from the outside, the feet are easily positioned and electrical tests are possible.

### Type

Potting Box: H-RG 16.5/16.5/9.1/14f-640-/torA504  
Solder-pin: fw640-70/ub

### Order-Code

66375-132  
75890-213

### Accessories

#### wound toroidal core

diameter  $\varnothing$  16.5/ $\varnothing$  0.650  
width 7.6/ $\varnothing$  0.299

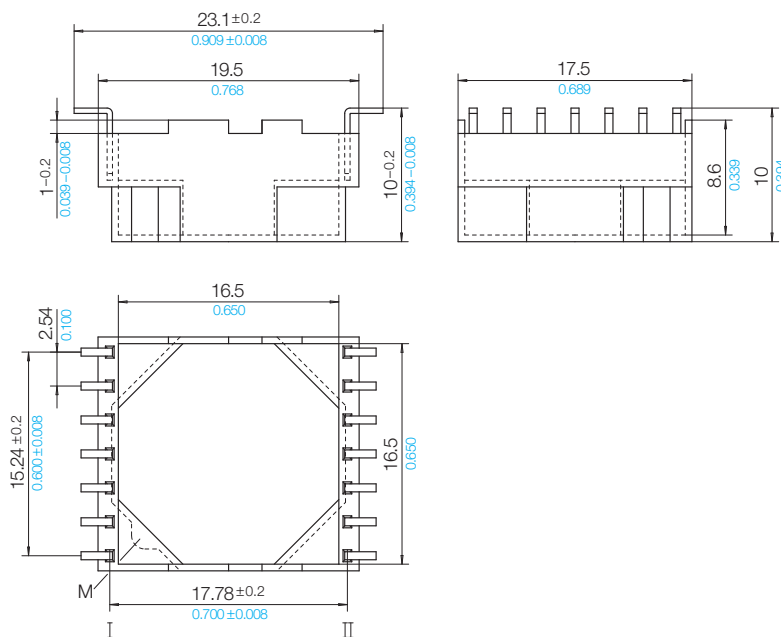

### Pin Connecting Surface View pin-side

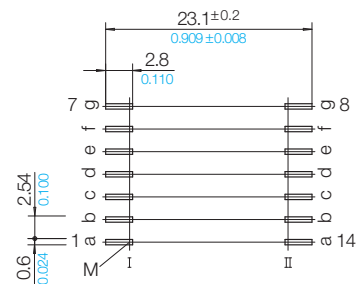

© 11/2016 by NORWE GmbH

Warranties:  
refer to Terms and Conditions of Sale

NORWE GmbH

Postfach 13 56  
51691 Bergneustadt  
Paulstraße 5, Pernze  
51702 Bergneustadt  
Deutschland

Telefon +49 (0) 27 63-807-0  
Telefax +49 (0) 27 63-807-77  
E-mail [verkauf@norwe.de](mailto:verkauf@norwe.de)  
Internet [www.norwe.de](http://www.norwe.de)  
[www.norwe.eu](http://www.norwe.eu)

NORWE Inc.

P.O. Box 25 11  
North Canton, OH 44720-0511  
United States of America  
Telefon +1-330 497-8113  
Telefax +1-330 305-0592  
E-mail [usa@norwe.com](mailto:usa@norwe.com)  
Internet [www.norwe.com](http://www.norwe.com)



Valid version of  
data sheet online

QR Online-Version