

Insulating Caps ID

The insulating caps are made in gfr Polyamide PA66 of type p6g nat. (RTI long-range temperature +125°C).

Special materials – e.g. irradiated cross-linked – and designs on request, dimensions in mm/*inch*.

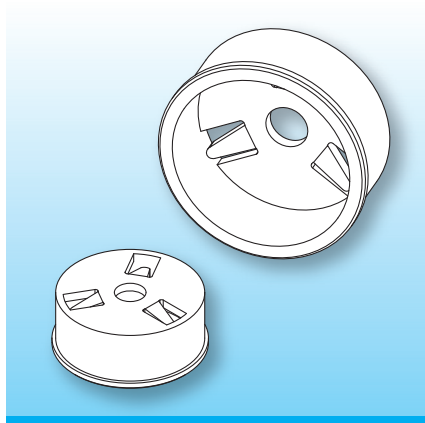

The insulating cap together with the connecting board provide mechanical protection for the potcores and electrical insulation. Together they form a compact component for easy pcb-mounting. The design of the Snap-in Cap also eliminates the use of spring-washers.

Type	Order-Code	A	B	C	D	E	F
ID 9 x 5 / p6g nat.	16001-009	9.4 0.370	11.0 0.433	3.8 0.150	3.3 0.130	2.2 0.087	10.6 0.417
ID 9 x 5 / p6g nat.	N0155-009	9.5 0.374	10.7 0.421	5.3 0.209	4.5 0.177	2.4 0.094	10.7 0.421
ID 11 x 7 / p6g nat.	16011-009	11.5 0.453	13.2 0.520	5.4 0.213	4.6 0.181	2.4 0.094	12.7 0.500
ID 14 x 8 / p6g nat.	16021-009	14.4 0.567	16.8 0.661	6.8 0.268	5.8 0.228	3.4 0.134	16.0 0.630
ID 18 x 11 / p6g nat.	16031-009	18.4 0.724	20.8 0.819	8.6 0.339	7.6 0.299	3.4 0.134	20.0 0.787
ID 22 x 13 / p6g nat.	N0156-009	22.2 0.874	24.6 0.969	10.8 0.425	9.8 0.386	4.6 0.181	23.8 0.937
ID 26 x 16 / p6g nat.	N0157-009	26.6 1.047	28.6 1.126	12.4 0.488	11.4 0.449	5.6 0.220	28.6 1.126
ID 30 x 19 / p6g nat.	N0158-009	30.6 1.205	33.0 1.299	14.8 0.583	13.8 0.543	5.6 0.220	32.2 1.268
ID 32 x 22 / p6g nat.	N0159-009	36.2 1.425	38.6 1.520	16.4 0.646	15.4 0.606	5.6 0.220	37.8 1.488

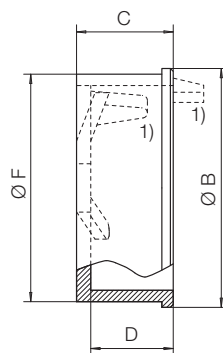
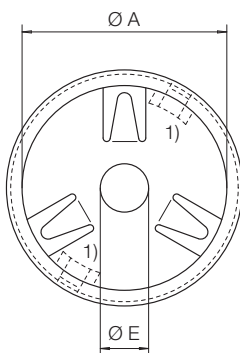

1) only for 16001

© 05/2017 by NORWE GmbH

Warranties:
refer to Terms and Conditions of Sale

NORWE GmbH

Postfach 13 56
51691 Bergneustadt
Paulstraße 5, Pernze
51702 Bergneustadt
Deutschland

Telefon +49 (0) 27 63-807-0
Telefax +49 (0) 27 63-807-77
E-mail verkauf@norwe.de
Internet www.norwe.de
www.norwe.eu

NORWE Inc.

P.O. Box 25 11
North Canton, OH 44720-0511
United States of America
Telefon +1-330 497-8113
Telefax +1-330 305-0592
E-mail usa@norwe.com
Internet www.norwe.com



Valid version of
data sheet online

QR Online-Version