

## RM Power Conversion 45°, Specials

The coilformers are made in gfr Polyamide PA66 of type p6g (RTI long-range temperature +125° C).  
Pin material: tin bronze, tinned.  
Maximum solder temperature 350° C, 2 sec.  
Special materials – eg. irradiated cross-linked – and designs on request, dimensions in mm/*inch*.

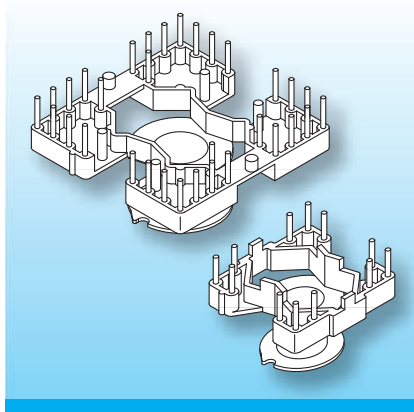

The pin layout on the lower flange of these specially designed coilformers allows simultaneous binding-on and winding of two wires (bi-filar).

Compared with standard RM-coilformers, 12–32 solder-pins are available. In addition, winding and soldering can be done fully automatic.

Type	Order-Code	Accessories
Coilformer: RM 6/1k/20-8/p6g Solder-pin: z809/ua	90032-024 73295-212	

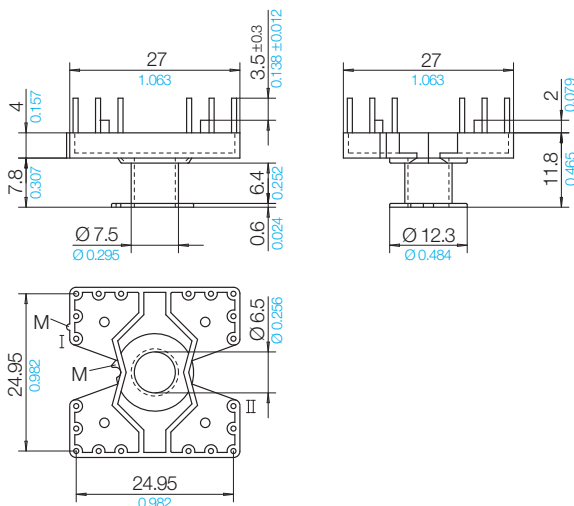

**Grid**  
View pin-side

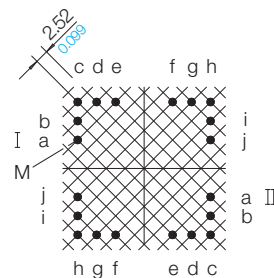

© 11/2011 by NORWE GmbH

All dimensions in mm/inch

The permissible deviations according to DIN 16901 apply as tolerances

Warranties:  
refer to Terms and Conditions of Sale

**NORWE GmbH**

Postfach 13 56  
51691 Bergneustadt  
Paulstraße 5, Pernze  
51702 Bergneustadt  
Deutschland  
Telefon +49 (0) 27 63-807-0  
Telefax +49 (0) 27 63-807-77  
E-mail verkauf@norwe.de  
Internet www.norwe.de  
www.norwe.eu

**NORWE Inc.**

P.O. Box 25 11  
North Canton, OH 44720-0511  
United States of America  
Telefon +1-330 497-8113  
Telefax +1-330 305-0592  
E-mail usa@norwe.com  
Internet www.norwe.com