

## ETD Safety Class Coilformers Concentric Design

The coilformers are made in gr Polyamide PA66 of type A RV250 nat. (RTI long-range temperature +100° C). The solder-tags are punched from brass and are subsequently tinned. Max. solder temperature +350° C, 2 sec. Special materials – e.g. irradiated cross-linked – and designs on request, dimensions in mm/inch.

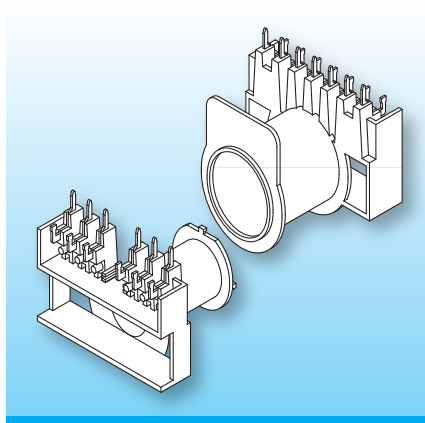

The ETD safety class coilformers have the advantage that the primary and secondary windings are wound separately on the coilformer halves, with the two windings pushed together to form a complete winding assembly.

Elaborate description of the designs please see catalogue-info.

### Type

Coilformer: ETD 34/prim/s-/5.08-m/A RV250 nat.  
Solder-tag: s18/wd

### Order-Code

90695-106  
75511-261

### Accessories

on request

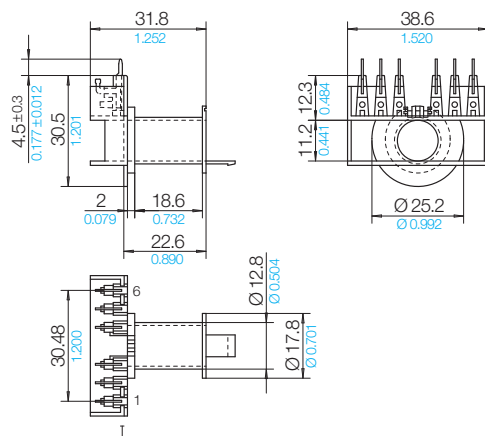

### Grid

View tag-side

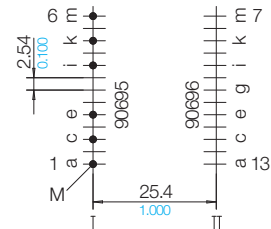

02 B 2 S

### © 10/2021 by NORWE GmbH

All dimensions in mm/inch

The permissible deviations according to DIN 16901 apply as tolerances

Warranties:  
refer to Terms and Conditions of Sale



Valid version of  
data sheet online

QR Online-Version

### NORWE GmbH

Paulstraße 5, Pernze  
51702 Bergneustadt  
Deutschland

Telefon +49 (0) 27 63-807-0  
E-mail verkauf@norwe.de  
Internet www.norwe.de  
www.norwe.eu

### NORWE Inc.

P.O. Box 25 11  
North Canton, OH 44720-0511  
United States of America

Telefon +1-330 497-8113  
E-mail usa@norwe.com  
Internet www.norwe.com